

**Site Inventory Form**  
**State Historical Society of Iowa**  
 (November 2005)

State Inventory No. 09-00826

New  Supplemental

Part of a district with known boundaries (enter inventory no.) 09-00621

Relationship:  Contributing  Noncontributing

Contributes to a potential district with yet unknown boundaries

National Register Status:(any that apply)  Listed  De-listed  NHL  DOE

9-Digit SHPO Review & Compliance (R&C) Number \_\_\_\_\_

Non-Extant (enter year) \_\_\_\_\_

**1. Name of Property**

historic name Cook, Julia J., House

other names/site number \_\_\_\_\_

**2. Location**

street & number 303 6<sup>th</sup> St NW

city or town Waverly

vicinity, county Bremer

Legal Description: (If Rural) Township Name \_\_\_\_\_

Township No. \_\_\_\_\_

Range No. \_\_\_\_\_

Section \_\_\_\_\_

Quarter of Quarter \_\_\_\_\_

(If Urban) M.N. LeValley Add.

Block(s) 59

Lot(s) Lots 7 & 8 "EX N 8 1/4"

**3. State/Federal Agency Certification [Skip this Section]**

**4. National Park Service Certification [Skip this Section]**

**5. Classification**

Category of Property (Check only one box)

- building(s)
- district
- site
- structure
- object

Number of Resources within Property

*If Non-Eligible Property*

Enter number of:

— buildings  
 — sites  
 — structures  
 — objects  
 — Total

*If Eligible Property, enter number of:*

Contributing      Noncontributing

1      1 buildings  
 —      — sites  
 —      — structures  
 —      — objects  
1      1 Total

Name of related project report or multiple property study (Enter "N/A" if the property is not part of a multiple property examination).

Title

Waverly's NW & SE Neighborhoods Historical & Architectural Survey

Historical Architectural Data Base Number

09-028

**6. Function or Use**

Historic Functions (Enter categories from instructions)

01A03 Single Dwelling

Current Functions (Enter categories from instructions)

01A03 Single Dwelling

01C05 Garage

**7. Description**

Architectural Classification (Enter categories from instructions)

09A09 Cross-Gabled Roof (2-story)

Materials (Enter categories from instructions)

foundation 04 Stone

walls (visible material) 02A Wood/Weatherboard

roof 08A Asphalt/Shingle

other \_\_\_\_\_

**Narrative Description** ( SEE CONTINUATION SHEETS, WHICH MUST BE COMPLETED)

**8. Statement of Significance**

Applicable National Register Criteria (Mark "x" representing your opinion of eligibility after applying relevant National Register criteria)

- Yes  No  More Research Recommended
- Yes  No  More Research Recommended
- Yes  No  More Research Recommended
- Yes  No  More Research Recommended

- A Property is associated with significant events.
- B Property is associated with the lives of significant persons.
- C Property has distinctive architectural characteristics.
- D Property yields significant information in archaeology or history.

County Bremer  
City Waverly

Address 303 6<sup>th</sup> St NW

Site Number 09-00826  
District Number 09-00621

**Criteria Considerations**

- A Owned by a religious institution or used for religious purposes.
- B Removed from its original location.
- C A birthplace or grave.
- D A cemetery.
- E A reconstructed building, object, or structure.
- F A commemorative property.
- G Less than 50 years of age or achieved significance within the past 50 years.

**Areas of Significance** (Enter categories from instructions)

02 ARCHITECTURE

**Significant Dates**

*Construction date*  
1894  check if circa or estimated date  
*Other dates, including renovation*  
Garage - 2002

**Significant Person**

(Complete if National Register Criterion B is marked above)

**Architect/Builder**

*Architect*

*Builder*

**Narrative Statement of Significance** ( SEE CONTINUATION SHEETS, WHICH MUST BE COMPLETED)

**9. Major Bibliographical References**

**Bibliography**  See continuation sheet for citations of the books, articles, and other sources used in preparing this form

**10. Geographic Data**

**UTM References** (OPTIONAL)

Zone	Easting	Northing	Zone	Easting	Northing
1	_____	_____	2	_____	_____
3	_____	_____	4	_____	_____

See continuation sheet for additional UTM references or comments

**11. Form Prepared By**

name/title Marlys Svendsen, Svendsen Tyler, Inc.  
organization for City of Waverly, Historic Preservation Commission  
street & number N3834 Deep Lake Road  
city or town Sarona state WI  
date 9/2013  
telephone 715/469-3300  
zip code 54870

**ADDITIONAL DOCUMENTATION** (Submit the following items with the completed form)

**FOR ALL PROPERTIES**

- Map:** showing the property's location in a town/city or township.
- Site plan:** showing position of buildings and structures on the site in relation to public road(s).
- Photographs:** representative black and white photos. If the photos are taken as part of a survey for which the Society is to be curator of the negatives or color slides, a photo/catalog sheet needs to be included with the negatives/slides and the following needs to be provided below on this particular inventory site:

Roll/slide sheet # _____	Frame/slot # _____	Date Taken _____
Roll/slide sheet # _____	Frame/slot # _____	Date Taken _____
Roll/slide sheet # _____	Frame/slot # _____	Date Taken _____

- See continuation sheet or attached *photo & slide catalog sheet* for list of photo roll or slide entries.
- Photos/illustrations without negatives are also in this site inventory file.

**FOR CERTAIN KINDS OF PROPERTIES, INCLUDE THE FOLLOWING AS WELL**

- Farmstead & District:** (List of structures and buildings, known or estimated year built, and contributing or noncontributing status)
- Barn:**
  - A sketch of the frame/truss configuration in the form of drawing a typical middle bent of the barn.
  - A photograph of the loft showing the frame configuration along one side.
  - A sketch floor plan of the interior space arrangements along with the barn's exterior dimensions in feet.

**State Historic Preservation Office (SHPO) Use Only Below This Line**

Concur with above survey opinion on National Register eligibility:  Yes  No  More Research Recommended  
 This is a locally designated property or part of a locally designated district.

Comments: \_\_\_\_\_

Evaluated by (name/title): \_\_\_\_\_ Date: \_\_\_\_\_

# Iowa Site Inventory Form Continuation Sheet

Page 1

---

Cook, Julia, House	Bremer
Name of Property	County
303 6 <sup>th</sup> St NW	Waverly
Address	City

---

## 7. Description

This single-family house is estimated to have been built in 1894 according to Bremer County Assessor records. The house form is typical of large houses built in Waverly from the 1890s through the early 1900s. Bremer County Property Transfer Records show Hattie Burke selling the lots in Block 59 of M. N. LeValley's Addition in 1899 to Julia Cook, possibly her mother. The 1899 city directory shows Julia residing there. The house appears on the 1894 Sanborn Map. Therefore, a construction date of ca. 1894 is consistent with public records for this property.

This 2-story frame house is an example of a vernacular Cross-Gabled Roof house form. The house has a parged stone foundation with medium-width wood clapboard-style siding and cornerboard trim on the lower walls; fish scale shingles are in the gable peaks. The house has a moderate pitched intersecting gable roof with broad gable ends lined by dentiled cornices edges and with returning cornices. A small L-shaped entrance porch is at the northeast corner with a flat roof and square-cut wood shingles on the short mansard edge. Square half-columns at the corners rest on the clapboard clad closed balustrade. The porch has a rock foundation (non-original). The rear wing has a porch extending along the south façade with narrow posts set along the front edge with no balustrade. The roof is an extension of the side gabled slope.

Fenestration includes single, paired and grouped 1/1 double-hung windows with dentiled edges on crown moldings. A large rectangular bay window on the south façade has a flat roof with a short mansard edge clad in square-cut wood shingles. A band of panels is set beneath dentiled molding courses. Tall and narrow 1/1 double-hung windows line the walls. An ocular keystone window is centered on the south façade, second floor. Tall 1/1 windows are centered beneath the gable peaks. A detached double-bay front-gable garage is at the rear opening onto 3<sup>rd</sup> Ave NW; it was built in 2002 according to Assessor records.

Alterations: garage (2002); porch foundation, balustrade and posts (undated).

## 8. Significance

The Julia J. Cook House at 303 6<sup>th</sup> St NW was built in ca. 1894 and is an example of a vernacular Cross-Gabled Roof house form. The house qualifies for the National Register of Historic Places as a contributing resource to the historic district under Criteria A and C.

Property transfer records show Hattie Burke and her husband transferring this house to Julia J. Cook, a widow, in 1899. Julia had three daughters including, Ruth, Hattie and Elma, who resided with her mother at this address in 1899 while working as a teacher. The house remained in Julia's ownership until 1938 when it was transferred by referee's deed to A. (August) and Otilie Matthias. August was a minister who died in 1953 and his wife, Otilie, was still residing here in 1957.

## 9. Sources

*Atlas of Bremer County, Iowa.* Waverly, Iowa: Waverly Publishing Company, 1917.

Iowa Department of Cultural Affairs  
State Historical Society of Iowa  
**Iowa Site Inventory Form  
Continuation Sheet**

Site Number 09-00826  
Related District Number 09-00621

Page 2

---

Cook, Julia, House	Bremer
Name of Property	County
303 6 <sup>th</sup> St NW	Waverly
Address	City

---

*Atlases of Bremer County.* Microfilm copies of atlases for 1875, 1894 and 1927, Waverly Public Library.

Bremer County History Book Committee. *Bremer County History, 1985.* Dallas, Texas: Taylor Publishing, 1985.

Grawe, Joseph F. *History of Bremer County, Iowa, Volumes I and II.* Chicago: S.J. Clarke Company, 1914.

*History of Butler and Bremer Counties, Iowa.* Springfield, Illinois: Union Publishing, 1883.

Property Transfer Records, Bremer County Auditor's Office.

Sanborn Company Maps. New York: Sanborn Map Company, 1885, 1892, 1897, 1905, 1915, 1927, and 1927 updated to 1943.

Vertical file collection, Waverly Public Library.

Waverly building histories, miscellaneous bound volumes in reference collection, Waverly Public Library.

Waverly Business News Index (database), Waverly Public Library.

Waverly city directories, 1899 and 1913.

Waverly Heritage Days historical walking tour brochures for 1995, 1996, 1997, 1998, 1999 and 2000.

Waverly Historic Photo Collection, Waverly Public Library.

Waverly Newspapers.

Iowa Department of Cultural Affairs  
State Historical Society of Iowa  
**Iowa Site Inventory Form  
Continuation Sheet**

Site Number 09-00826  
Related District Number 09-00621

Page 3

Cook, Julia, House  
Name of Property  
303 6<sup>th</sup> St NW  
Address

Bremer  
County  
Waverly  
City

**Site Map:** Bremer County GIS Department, 12/2011.

**303 6th St NW  
PIN 09-03-237-007**

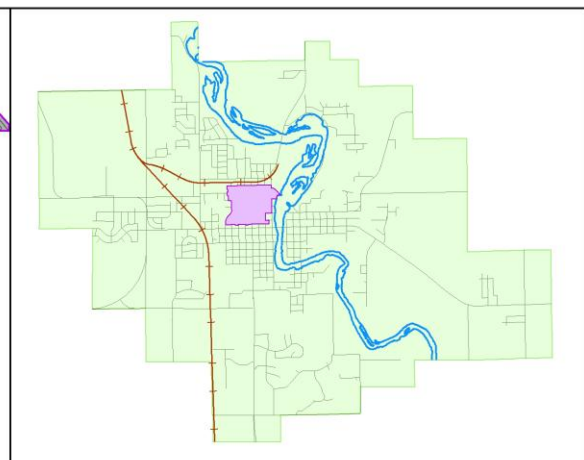

Iowa Department of Cultural Affairs  
State Historical Society of Iowa  
**Iowa Site Inventory Form  
Continuation Sheet**

Site Number 09-00826  
Related District Number 09-00621

Page 4

Cook, Julia, House  
Name of Property  
303 6<sup>th</sup> St NW  
Address

Bremer  
County  
Waverly  
City

**Photographs:** 303 6th St NW, looking northwest and west, Marlys Svendsen, Svendsen Tyler, Inc., photographer, 11/16/2011.



Iowa Department of Cultural Affairs  
State Historical Society of Iowa  
**Iowa Site Inventory Form  
Continuation Sheet**

Site Number 09-00826  
Related District Number 09-00621

Page 5

---

Cook, Julia, House  
Name of Property  
303 6<sup>th</sup> St NW  
Address

---

Bremer  
County  
Waverly  
City

---

**Photograph:** 303 6th St NW, looking southwest and gable end, looking south, Marlys Svendsen, Svendsen Tyler, Inc., photographer, 11/16/2011.



Iowa Department of Cultural Affairs  
State Historical Society of Iowa  
**Iowa Site Inventory Form  
Continuation Sheet**

Site Number 09-00826  
Related District Number 09-00621

Page 6

---

Cook, Julia, House  
Name of Property  
303 6<sup>th</sup> St NW  
Address

---

Bremer  
County  
Waverly  
City

---

**Photograph:** 303 6th St NW, looking north and garage, looking west, Marlys Svendsen, Svendsen Tyler, Inc., photographer, 11/16/2011.





Iowa Department of Cultural Affairs  
State Historical Society of Iowa  
**Iowa Site Inventory Form  
Continuation Sheet**

Site Number 09-00826  
Related District Number 09-00621

Page 7

Cook, Julia, House  
Name of Property  
303 6<sup>th</sup> St NW  
Address

Bremer  
County  
Waverly  
City

**Photographs:** 303 6th St NW, looking northwest, Justine Zimmer, IHSEMD, photographer, 4/24/2009.



Iowa Department of Cultural Affairs  
 State Historical Society of Iowa  
**Iowa Site Inventory Form**  
**Continuation Sheet**

Site Number 09-00826  
 Related District Number 09-00621

Page 8

Cook, Julia, House	Bremer
Name of Property	County
303 6 <sup>th</sup> St NW	Waverly
Address	City

Additional Information:

Floor plan, 303 6th St NW, Bremer County Assessor website; available at <http://beacon.schneidercorp.com/PhotoEngine/Sketch.aspx?appid=330&keyvalue=0903237007&index=0&size=0>; 6/17/2013.

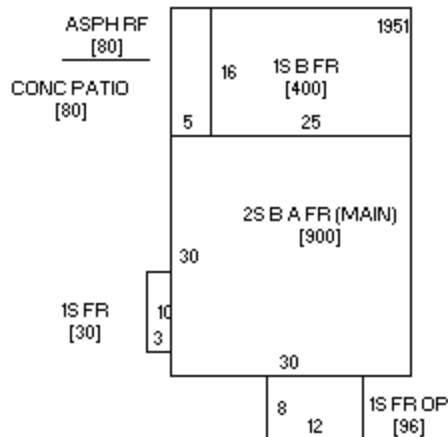
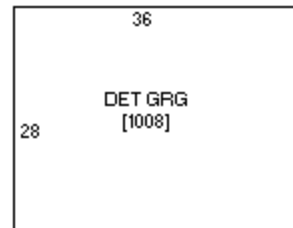

Sketch by [www.camavision.com](http://www.camavision.com)